



IL COSTRUTTORE SI RISERVA IL DIRITTO DI APPORTARE MODIFICHE DI MATERIALI E DI MODELLI SENZA PREAVVISO. I PESI, LE MISURE, ECC., SONO SEMPLICEMENTE FORNITI A TITOLO INDICATIVO E NON IMPEGNANO IL COSTRUTTORE. • WE RESERVE THE RIGHT TO MAKE CHANGES EITHER IN THE MATERIALS USED OR IN THE MODELS WITHOUT NOTICE. WEIGHTS, DIMENSIONS ETC. ARE GIVEN PURELY AS AN INDICATION AND THEY DO NOT ENGAGE THE MANUFACTURER. • LE CONSTRUCTEUR SE RÉSERVE LE DROIT D'APPORTER TOUTES MODIFICATIONS UTILES SUR LES COMPOSANTS ET LES MODÈLES SANS PRÉAVIS. LES POIDS, LES DIMENSIONS CARACTÉRISTIQUES SONT SIMPLEMENT FOURNIES A TITRE INDICATIF ET N'ENGAGENT PAS LE CONSTRUCTEUR. • DIE HERSTELLERFIRMA BEHAHLT SICH DAS RECHT VOR, OHNE VORHERIGE BENÄCHTIGUNG AN MATERIAL UND AUSFÜHRUNG ÄNDERUNGEN VORZUNEHMEN, DIE GEWICHTE UND VERPFLICHTEN NICHT DEN HERSTELLER. • EL CONSTRUCTOR SE RESERVA EL DERECHO DE INTRODUCIR MODIFICACIONES EN LOS MATERIALES Y MODELOS SIN PREAVISO EL PESO, MEDIDAS, ETC. SON DADAS SIMPLEMENTE A TITULO INFORMATIVO, SIN QUE ESTO OBLIGUE AL CONSTRUCTOR.



Tecfrigo produce frigoriferi perseguendo il profilo di massima qualità, frutto di un accurato lavoro di ricerca, dell'utilizzo di componenti di gamma top class e dell'adozione di tutte le misure tese al miglioramento del processo produttivo. I frigoriferi Tecfrigo sono innovativi per ergonomia e design, curati alla perfezione nei dettagli, affidabili e garantiti nel tempo, assistiti secondo le specifiche della qualità totale. Questo impegno ha permesso a Tecfrigo di ottenere la certificazione del sistema qualità aziendale in conformità alla norma DIN EN ISO 9001:2000

ZD8850105 / DATAPoint © roma • parigi • new york

ExpoEis 3/2

G E L A T E R I A

ICE CREAM

GLACIER

EISDIELE

HELADERIA

	<i>Eco 4 RI</i>	<i>Eco 6 C</i>	<i>Eco 7 C</i>
POTENZA NOMINALE, NOMINAL POWER, PUISSANCE NOMINALE, NENNLEISTUNG, POTENCIA NOMINAL	Watt 450	Watt 540	Watt 550
TEMPERATURA, TEMPERATURE, TEMPERATURE, TEMPERATUR, TEMPERATURA	°C -15/-18	°C -15/-18	°C -15/-18
SBRINAMENTO, DEFROSTING, DEGIVRAGE, ENTEISUNG, DESESCARCHE			
REFRIGERAZIONE, REFRIGERATION, REFRIGERATION, KUEHLUNG, REFRIGERACION			
TENSIONE, TENSION, TENSION, SPANNUNG, TENSION	230v/50Hz	230v/50Hz	230v/50Hz
CON RISERVA, WITH RESERVE, AVEC RESERVE, MIT RESERVE, CON RESERVA	•	—	—
CON CELLA, WITH COLD STORE, AVEC CHAMBRE FROIDE, MIT KÜHLZELLE, COMPARTIMENTO REFRIGERADO	—	•	•
PESO, WEIGHT, POIDS, GEWICHT, PESO	Kg 83	Kg 91	Kg 113

Dati di collaudo
Test details
Détails d'essai
Prüfungsergebnisse
Datos de ensayo
MAX = (30°C - % U.R. 55)

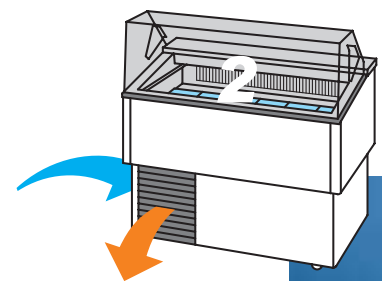
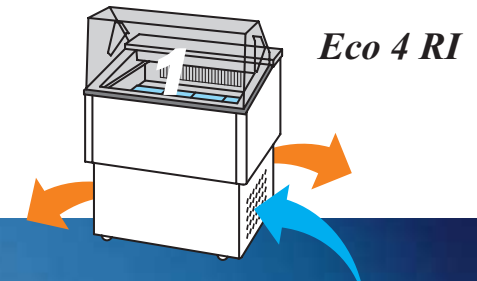
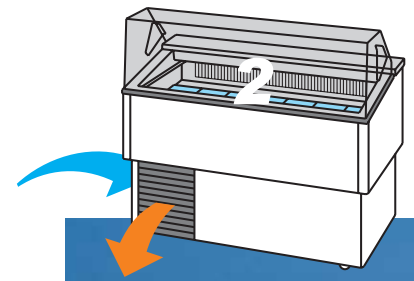

Eco 6 C



Eco 7 C

POTENZA NOMINALE, NOMINAL
POWER, PUISSANCE NOMINALE,
NENNLEISTUNG, POTENCIA NOMINAL

Watt
720

Watt
840

TEMPERATURA, TEMPERATURE,
TEMPERATURE, TEMPERATUR,
TEMPERATURA

°C
-16/-18

°C
-16/-18

SBRINAMENTO, DEFROSTING,
DEGIVRAGE, ENTEISUNG,
DESESCARCHE



REFRIGERAZIONE, REFRIGERATION,
REFRIGERATION, KUEHLUNG,
REFRIGERACION



TENSIONE, TENSION,
TENSION, SPANNUNG,
TENSION

230v/50Hz

230v/50Hz

PESO, WEIGHT,
POIDS, GEWICHT,
PESO

Kg 102

Kg 127

Dati di collaudo
Test details
Détails d'essai
Prüfungsergebnisse
Datos de ensayo
MAX = (30°C - % U.R. 55)

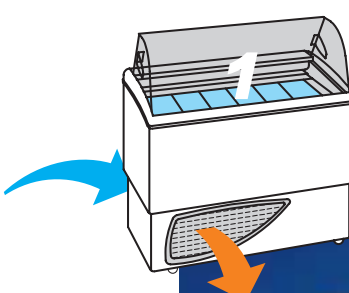
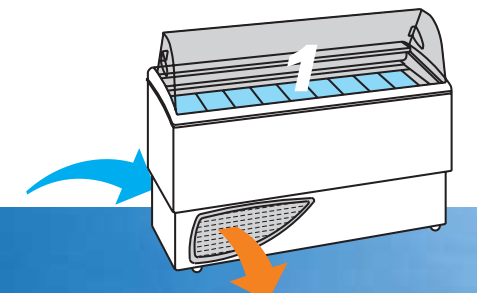

Limited 6 RI



Limited 9 RI

Limited



POTENZA NOMINALE, NOMINAL
POWER, PUISSANCE NOMINALE,
NENNLEISTUNG, POTENCIA NOMINAL

Carisma 6+6	Carisma 7+7
Watt 725	Watt 755

TEMPERATURA, TEMPERATURE,
TEMPERATURE, TEMPERATUR,
TEMPERATURA

Carisma 6+6	Carisma 7+7
°C -16/-18	°C -16/-18

SBRINAMENTO, DEFROSTING,
DEGIVRAGE, ENTEISUNG,
DESESCARCHE

Carisma 6+6	Carisma 7+7
	

REFRIGERAZIONE, REFRIGERATION,
REFRIGERATION, KUEHLUNG,
REFRIGERACION

Carisma 6+6	Carisma 7+7
	

TENSIONE, TENSION,
TENSION, SPANNUNG,
TENSION

Carisma 6+6	Carisma 7+7
230v/50Hz	230v/50Hz

PESO, WEIGHT,
POIDS, GEWICHT,
PESO

Carisma 6+6	Carisma 7+7
Kg 115	Kg 132

Dati di collaudo
Test details
Détails d'essai
Prüfungsergebnisse
Datos de ensayo
MAX = (30°C - % U.R. 55)

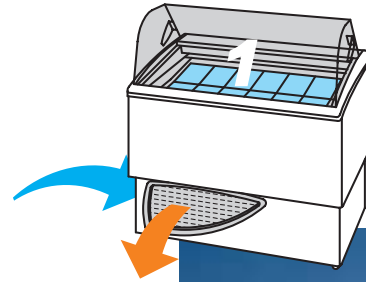

Carisma 6+6

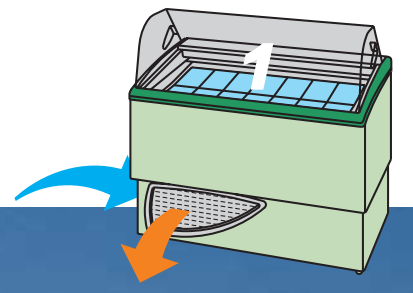

Carisma 7+7

	Evolution 12	Evolution 18	Evolution 24	Evolution 12+12
POTENZA NOMINALE, NOMINAL POWER, PUISSANCE NOMINALE, NENNLEISTUNG, POTENCIA NOMINAL	Watt 2520	Watt 3870	Watt 5100	Watt 2520x2
TEMPERATURA, TEMPERATURE, TEMPERATURE, TEMPERATUR, TEMPERATURA	°C -16/-18	°C -16/-18	°C -16/-18	°C -16/-18
SBRINAMENTO, DEFROSTING, DEGIVRAGE, ENTEISUNG, DESESCARCHE				
REFRIGERAZIONE, REFRIGERATION, REFRIGERATION, KUEHLUNG, REFRIGERACION				
TENSIONE, TENSION, TENSION, SPANNUNG, TENSION	230v/50Hz	230v/50Hz	400v/50Hz	230v/50Hz
PESO, WEIGHT, POIDS, GEWICHT, PESO	Kg 260	Kg 350	Kg 430	Kg 450

Dati di collaudo
Test details
DZtaills dOessai
Prüfungsergebnisse
Datos de ensayo
MAX = (30- % U.R. 55)

A mod. EVOLUTION
Vetro laterale con resistenza / *Side glass with heating element*
Verre latérale avec résistance / *Seitenglas mit Heizung*
Vidrio lateral con resistencia

B mod. EVOLUTION
Sistema antiappannaggio vetri frontali / *Non-fogging system for front glasses*
Système antibuée pour les vitres frontales / *System gegen das Beschlagen der Stirnglassscheiben* / Sistema antiempañamiento para vidrios frontales

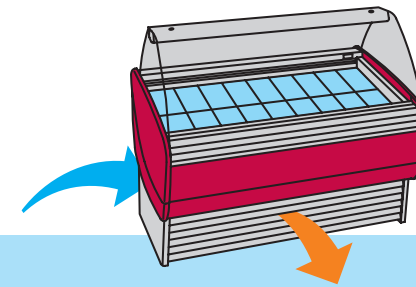

Fissaggio vetro curvo apribile
Openable curved glass fixing
Fissage vitre courbé ouvrant
Befestigung aufklappbare gebog Scheibe
Fisaje vidrio curvado

A

B

Evolution 18

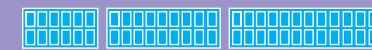

	<i>Gran Galà</i> 12	<i>Gran Galà</i> 16	<i>Gran Galà</i> 18
POTENZA NOMINALE, NOMINAL POWER, PUISSANCE NOMINALE, NENNLEISTUNG, POTENCIA NOMINAL	Watt 1130	Watt 1800	Watt 1830
TEMPERATURA, TEMPERATURE, TEMPERATURE, TEMPERATUR, TEMPERATURA	°C -16/-18	°C -16/-18	°C -16/-18
SBRINAMENTO, DEFROSTING, DEGIVRAGE, ENTEISUNG, DESESCARCHE			
REFRIGERAZIONE, REFRIGERATION, REFRIGERATION, KUEHLUNG, REFRIGERACION			
TENSIONE, TENSION, TENSION, SPANNUNG, TENSION	230v/50Hz	230v/50Hz	230v/50Hz
PESO, WEIGHT, POIDS, GEWICHT, PESO	Kg 260	Kg 315	Kg 340
<small>Dati di collaudo Test details Détails d'essai Prüfungsergebnisse Datos de ensayo MAX = (30°C - % U.R. 55)</small>			

	<i>Gran Galà</i> 20	<i>Gran Galà</i> 24	<i>Gran Galà</i> 12+12
POTENZA NOMINALE, NOMINAL POWER, PUISSANCE NOMINALE, NENNLEISTUNG, POTENCIA NOMINAL	Watt 1900	Watt 2520	Watt 2250
TEMPERATURA, TEMPERATURE, TEMPERATURE, TEMPERATUR, TEMPERATURA	°C -16/-18	°C -16/-18	°C -16/-18
SBRINAMENTO, DEFROSTING, DEGIVRAGE, ENTEISUNG, DESESCARCHE			
REFRIGERAZIONE, REFRIGERATION, REFRIGERATION, KUEHLUNG, REFRIGERACION			
TENSIONE, TENSION, TENSION, SPANNUNG, TENSION	230v/50Hz	400v/50Hz	230v/50Hz
PESO, WEIGHT, POIDS, GEWICHT, PESO	Kg 370	Kg 450	Kg 455
<small>Dati di collaudo Test details Détails d'essai Prüfungsergebnisse Datos de ensayo MAX = (30°C - % U.R. 55)</small>			

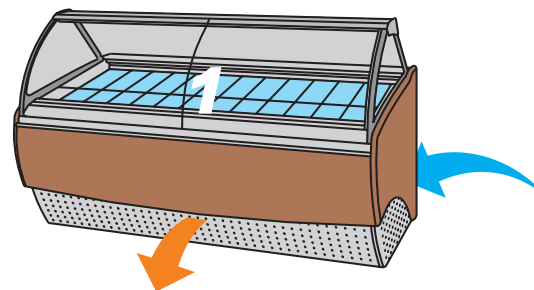

Gran Galà 12+12



Gran Galà 18
Legno

Gran Galà
12/16/18/20/24





*Gran Galà 24
Verde*



*Gran Galà 24
Ruggine*



*Gran Galà 24
Azzurra*



*Gran Galà 24
Fucsia*

OPTIONAL:
mod. CARISMA
GRAN GALÀ
LIMITED
EVOLUTION
AMBASSADOR
Porta coni
Cone holder
Porte-cornets
Eistütenhalter
Portacacuruchos

Se si desidera usare un settore della macchina per la conservazione delle granite "consultare la ditta.
If you wish to use a sector of the machine for conservation of "granita's" ask the factory.
Si vous voulez utiliser un secteur de la machine pour la conservation des granités, consultez la maison.
Wenn sie ein Sektor von der Maschine fuer Konservierung von Granita's utilisieren wollen, wenden sie sich an die Firma.
Se si quiere usar un sector de la maquina para la conservacion de las granillas consultar la dicta.

Vetri apribili
Opening glasses
Vitres ouvrantes
Glasscheibe, die man öffnen kann
Vidrios que se pueden abrir

mod. GRAN GALÀ / EVOLUTION
Tenda notte
Night curtain
Rideau pour la nuit
Gardine für die Nacht
Cortina para la noche

Vetro camera laterale riscaldato
Heated side termopan glass
Vitre termopan laterale chauffée
Beheizte seitliche Termopan-Glasscheibe
Vidrio termopan lateral calentado

OPTIONAL:
mod. CARISMA
GRAN GALÀ
LIMITED
EVOLUTION
AMBASSADOR
Lavaporzionatore con rubinetto esterno e porta cialde
Ice-cream serving spoon washer with outer tap and wafer holder
Lave-cuillère à servir sorbets et glaces avec robinet extérieur et porte-gaufrettes
Portioniererspüler mit Aussenhahn und Waffelhalter
Lavadora de cuchara servicio helado con grifo externo y porta barquillos

LxPxH mm.
375x115x400





OPTIONAL:
mod. GRAN GALÀ
EVOLUTION
AMBASSADOR
Ruote con e senza freno
Wheels with and without brake
Roues avec et sans frein
Räder mit und ohne Bremse
Ruedas con y sin freno





mod. GRAN GALÀ
Sistema antiappannaggio vetri frontali
Non-fogging system for front glasses
Système antibuée pour les vitres frontales
System gegen das Beschlagen der Stirnglassscheiben
Sistema antiempañamiento para vidrios frontales



OPTIONAL:
mod. GRAN GALÀ
EVOLUTION
AMBASSADOR
Vassoio inox per torte gelato
Inox tray for ice-cream cakes
Plateau en acier inox pour gâteaux glacés
Rostfreie Schale für Eistorten
Bandeja inox para tartas heladas



	Ambassador 12	Ambassador 18
POTENZA NOMINALE, NOMINAL POWER, PUISSANCE NOMINALE, NENNLEISTUNG, POTENCIA NOMINAL	Watt 2520	Watt 3870
TEMPERATURA, TEMPERATURE, TEMPERATURE, TEMPERATUR, TEMPERATURA	°C -16/-18	°C -16/-18
SBRINAMENTO, DEFROSTING, DEGIVRAGE, ENTEISUNG, DESESCARCHE		
REFRIGERAZIONE, REFRIGERATION, REFRIGERATION, KUEHLUNG, REFRIGERACION		
TENSIONE, TENSION, TENSION, SPANNUNG, TENSION	230v/50Hz	230v/50Hz
PESO, WEIGHT, POIDS, GEWICHT, PESO	Kg 260	Kg 350
<small>Dati di collaudo Test details Détails d'essai Prüfungsergebnisse Datos de ensayo MAX = (30°C - % U.R. 55)</small>		

	Ambassador 24	Ambassador 12+12
POTENZA NOMINALE, NOMINAL POWER, PUISSANCE NOMINALE, NENNLEISTUNG, POTENCIA NOMINAL	Watt 5100	Watt 2520x2
TEMPERATURA, TEMPERATURE, TEMPERATURE, TEMPERATUR, TEMPERATURA	°C -16/-18	°C -16/-18
SBRINAMENTO, DEFROSTING, DEGIVRAGE, ENTEISUNG, DESESCARCHE		
REFRIGERAZIONE, REFRIGERATION, REFRIGERATION, KUEHLUNG, REFRIGERACION		
TENSIONE, TENSION, TENSION, SPANNUNG, TENSION	400v/50Hz	230v/50Hz
PESO, WEIGHT, POIDS, GEWICHT, PESO	Kg 430	Kg 450
<small>Dati di collaudo Test details Détails d'essai Prüfungsergebnisse Datos de ensayo MAX = (30°C - % U.R. 55)</small>		

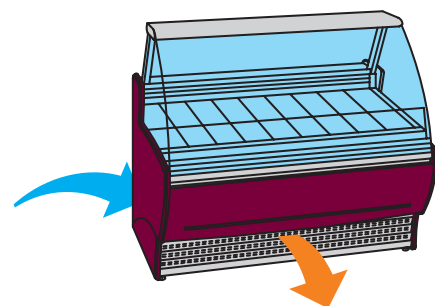

Ambassador 12+12



Ambassador 12/18/24



Ambassador 24



Vetri apribili
Opening glasses
Vitres ouvrantes
Glasscheibe, die man öffnen kann
Vidrios que se pueden abrir

Vetro camera laterale riscaldato
Heated side termopan glass
Vitre termopan laterale chauffée
Beheizte seitliche Termopan-Glasscheibe
Vidrio termopan lateral calentado

Vetro interno antiappannante
Antifogging internal glass
Vitre intérieur désembueur
Innere Scheibe antibeschlag
Vidrio interior antivaho abrivile

- Posizione dei pistoni accanto alle cerniere
- Pistons position near the hinges
- Position des pistons à côté de les charnières
- Kolbenstellung bei den Scharniern
- Posición de los pistones junto a las bisagras



mod. AMBASSADOR / EVOLUTION
Tenda notte
Night curtain
Rideau pour la nuit
Gardine für die Nacht
Cortina para la noche

Se si desidera usare un settore della macchina per la conservazione delle granite " consultare la ditta.

If you wish to use a sector of the machine for conservation of "granita's" ask the factory.

Si vous voulez utiliser un secteur de la machine pour la conservation des granités, consultez la maison.

Wenn sie ein Sektor von der Maschine fuer Konservierung von Granita's utilisieren wollen, wenden sie sich an die Firma.

Se si quiere usar un sector de la maquina para la conservacion de las granillas consultar la dicta.

mod. ECO / LIMITED / CARISMA
GRAN GALÀ / AMBASSADOR
EVOLUTION

Lavaporzionatore esterno con rubinetto
Outside ice-cream wash dosing with tap
Rince-doseur extérieur avec robinet
Äussere Eisdosierwaschschalen mit Hahn
Lavaporcionador externo con grifo

LxPxH mm.
315x120x230

ECO 4 RI

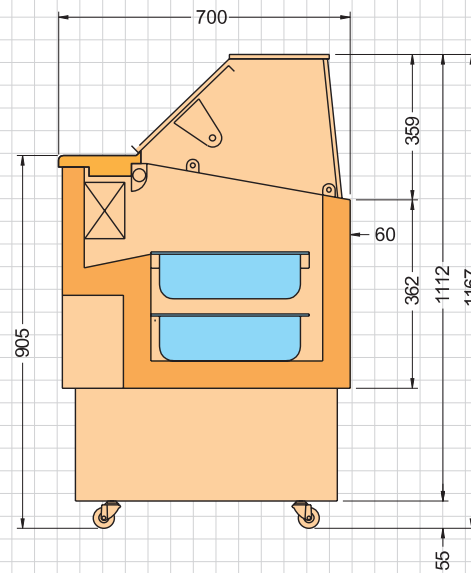

X/Z/T

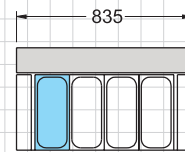

ECO 6 C / ECO 7 C

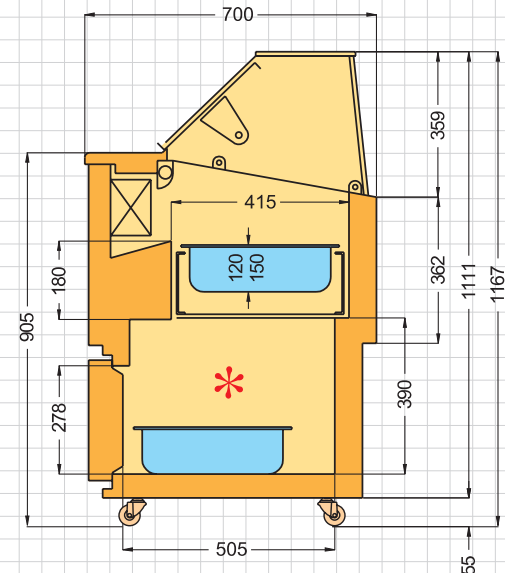

- Capacità cella Eco 6: n° 8 bacinelle tipo X
- Eco 6 cell capacity : no. 8 type X basins
- Capacité chambre Eco 6: 8 cuvettes type X
- Kapazität der Zelle Eco 6: Nr. 8 Becken Typ X
- Capacidad cámara Eco 6: n. 8 cubetas tipo X

- Capacità cella Eco 7: n° 12 bacinelle tipo X
- Eco 7 cell capacity : no. 12 type X basins
- Capacité chambre Eco 7: 12 cuvettes type X
- Kapazität der Zelle Eco 7: Nr. 12 Becken Typ X
- Capacidad cámara Eco 7: n. 12 cubetas tipo X

X/Z

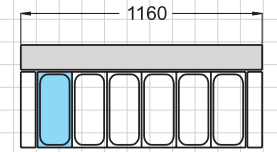

X/Z

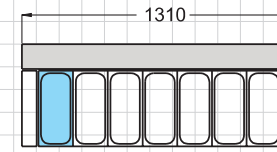

- PER RADDOPPIARE LA CAPACITÀ DI GELATO, LE VASCHETTE NON DEVONO SUPERARE h = mm.120.
- IN ORDER TO DOUBLE THE CAPACITY TO HOLD ICE-CREAM, THE HEIGHT OF THE BASINS MUST NOT EXCEED h = 120 mm.
- POUR DOUBLER LA CAPACITÉ DE CONTENIR DES GLACES, L'HAUTEUR DES BACS NE DOIT PAS DÉPASSER h = 120 mm.
- UM DAS EIS-FASSUNGSVERMÖGEN ZU VERDOPPELN, MUSS DIE HÖHE DER 120 mm. NICHT ÜBERSCHREITEN.
- PARA DOBLAR LA CAPACIDAD DE CONTENER HELADOS, LA ALTURA DE LAS CUBETAS NO DEBE REBASAR h = 120 mm.

X

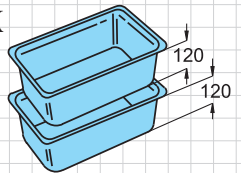

- LE VASCHETTE E I LAVAPORZIONATORI VENGONO FORNITI A RICHIESTA.
- BASINS AND ICE-CREAM WASH DOSINGS ARE AVAILABLE ON REQUEST.
- LES BACS ET LES RINCE-DOSEURS SONT FOURNIS SUR DEMANDE.
- DIE SCHALEN UND EISDOSIERWASCHSCHALEN WERDEN AUF WUNSCH GELIEFERT.
- LAS CUBETAS Y LOS LAVAPORCIONADORES SE ENTREGAN BAJO PEDIDO.

LIMITED 6 RI / 9 RI

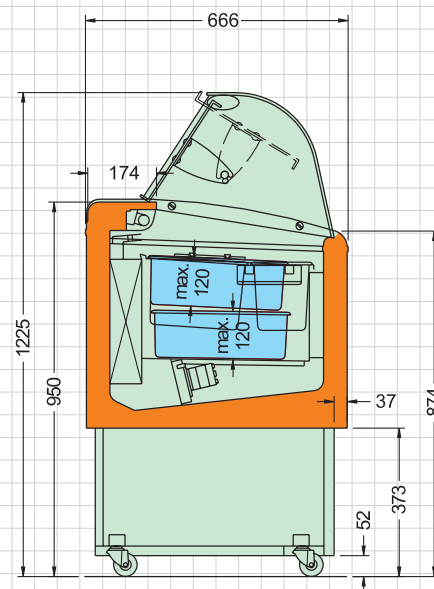

Cod. 09 (Bianco)

- PER RADDOPPIARE LA CAPACITÀ DI GELATO, LE VASCHETTE NON DEVONO SUPERARE h = mm.120.
- IN ORDER TO DOUBLE THE CAPACITY TO HOLD ICE-CREAM, THE HEIGHT OF THE BASINS MUST NOT EXCEED h = 120 mm.
- POUR DOUBLER LA CAPACITÉ DE CONTENIR DES GLACES, L'HAUTEUR DES BACS NE DOIT PAS DÉPASSER h = 120 mm.
- UM DAS EIS-FASSUNGSVERMÖGEN ZU VERDOPPELN, MUSS DIE HÖHE DER 120 mm. NICHT ÜBERSCHREITEN.
- PARA DOBLAR LA CAPACIDAD DE CONTENER HELADOS, LA ALTURA DE LAS CUBETAS NO DEBE REBASAR h = 120 mm.

X

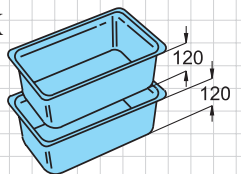

- LE VASCHETTE E I LAVAPORZIONATORI VENGONO FORNITI A RICHIESTA.
- BASINS AND ICE-CREAM WASH DOSINGS ARE AVAILABLE ON REQUEST.
- LES BACS ET LES RINCE-DOSEURS SONT FOURNIS SUR DEMANDE.
- DIE SCHALEN UND EISDOSIERWASCHSCHALEN WERDEN AUF WUNSCH GELIEFERT.
- LAS CUBETAS Y LOS LAVAPORCIONADORES SE ENTREGAN BAJO PEDIDO.

Limited 6 RI

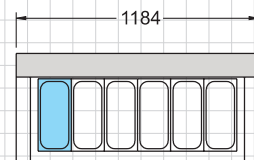

X/Z/T

Limited 9 RI

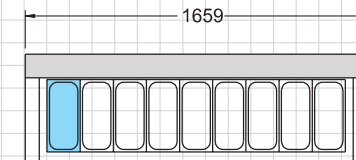

X/Z/T

Limited 6 RI

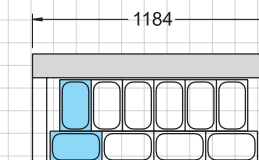

W

Limited 9 RI

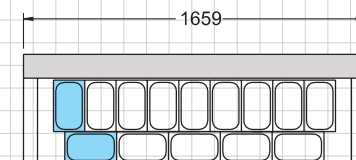

W

CARISMA 6+6

CARISMA 7+7

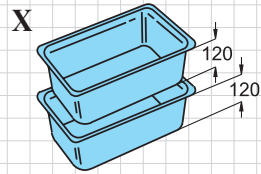

- PER RADDOPPIARE LA CAPACITÀ DI GELATO, LE VASCHE NON DEVONO SUPERARE h = mm.120.
- IN ORDER TO DOUBLE THE CAPACITY TO HOLD ICE-CREAM, THE HEIGHT OF THE BASINS MUST NOT EXCEED h = 120 mm.
- POUR DOUBLER LA CAPACITÉ DE CONTENIR DES GLACES, L'HAUTEUR DES BACS NE DOIT PAS DÉPASSER h = 120 mm.
- UM DAS EIS-FASSUNGSVERMÖGEN ZU VERDOPPELN, MUSS DIE HÖHE DER 120 mm. NICHT ÜBERSCHREITEN.
- PARA DOBLAR LA CAPACIDAD DE CONTENER HELADOS, LA ALTURA DE LAS CUBETAS NO DEBE REBASAR h = 120 mm.

- LE VASCHE E I LAVAPORZIONATORI VENGONO FORNITI A RICHIESTA.
- BASINS AND ICE-CREAM WASH DOSINGS ARE AVAILABLE ON REQUEST.
- LES BACS ET LES RINCE-DOSEURS SONT FOURNIS SUR DEMANDE.
- DIE SCHALEN UND EISDOSIERWASCHSCHALEN WERDEN AUF WUNSCH GELIEFERT.
- LAS CUBETAS Y LOS LAVAPORCIONADORES SE ENTREGAN BAJO PEDIDO.

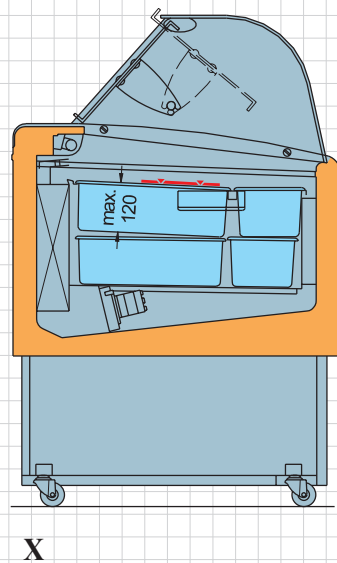
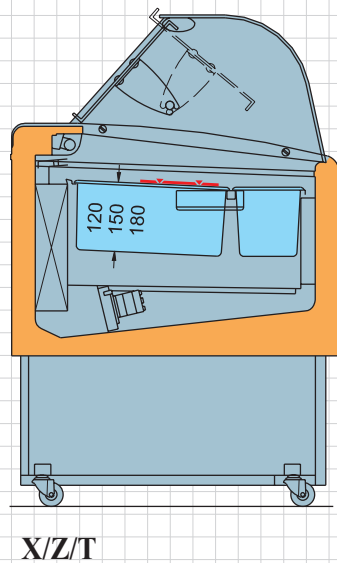
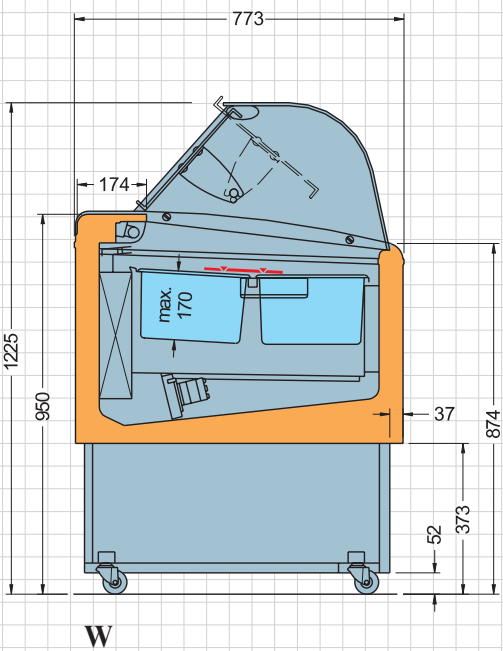
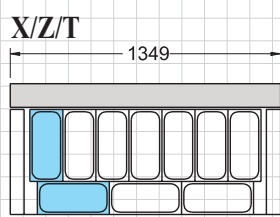
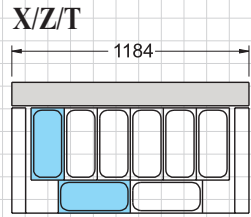
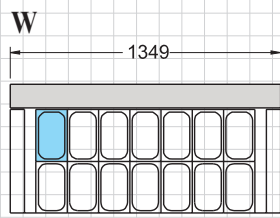
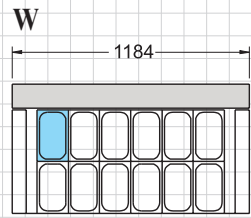
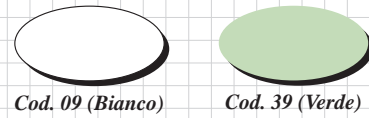

VASCHE - BASINS - BACS - BECKEN - CUBETAS

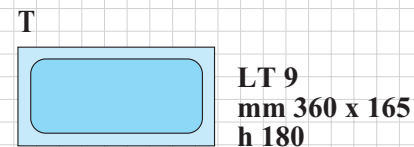
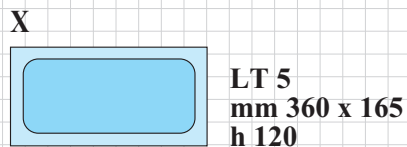
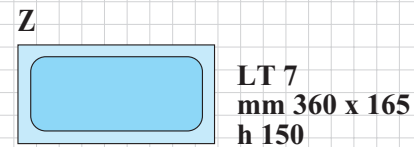
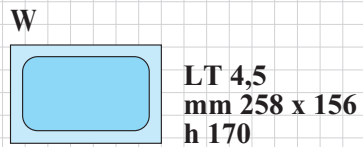

EVOLUTION 12 / 18 / 24 / 12+12

COD. 48 / 49 / 50 • DIMENSIONI CON PANNELLI • DIMENSIONS WITH PANELS
 • DIMENSIONS AVEC PANNEAUX • ABMESSUNGEN MIT VERKLEIDUNG • DIMENSIONES CON PANEL

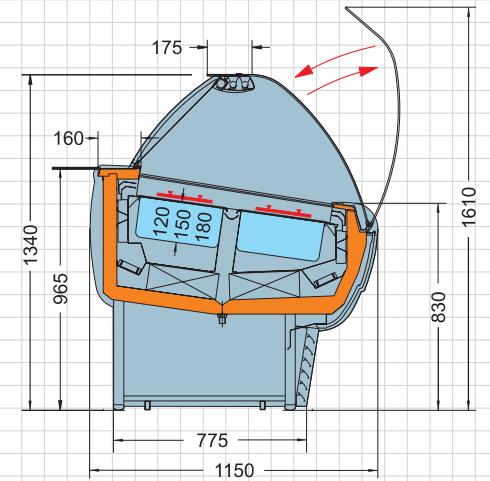
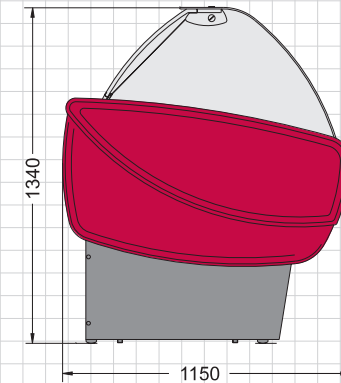
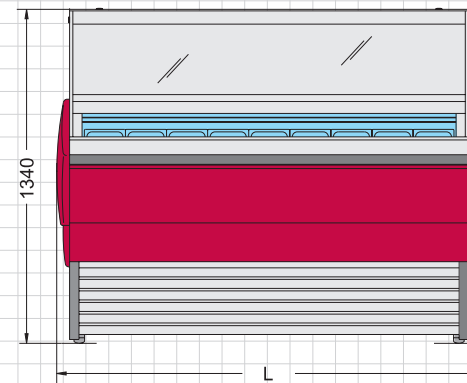
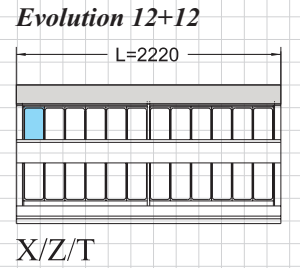
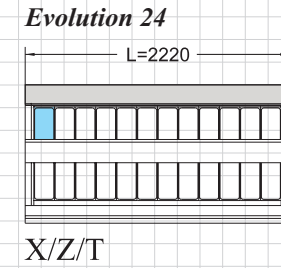
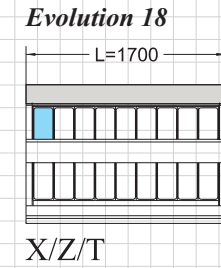
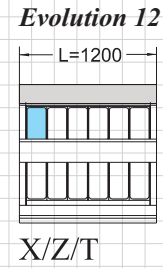

Colori metallizzati / Metalized colours
 Couleurs métallisées / Metallhaltige Farben
 Colores metalizados

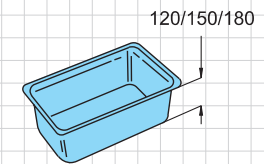
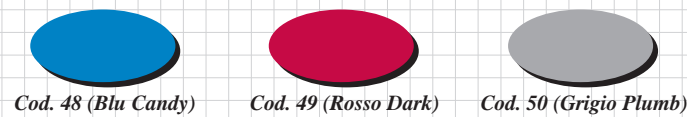

- LE VASCHE E I LAVAPORZIONATORI VENGONO FORNITI A RICHIESTA.
- BASINS AND ICE-CREAM WASH DOSINGS ARE AVAILABLE ON REQUEST.
- LES BACS ET LES RINCE-DOSEURS SONT FOURNIS SUR DEMANDE.
- DIE SCHALEN UND EISDOSIERWASCHSCHALEN WERDEN AUF WUNSCH GELIEFERT.
- LAS CUBETAS Y LOS LAVAPORCIONADORES SE ENTREGAN BAJO PEDIDO.

EVOLUTION 12 / 18 / 24 / 12+12

COD. 10 • DIMENSIONI SENZA PANNELLI • DIMENSIONS WITHOUT PANELS
 • DIMENSIONS SANS PANNEAUX • ABMESSUNGEN OHNE VERKLEIDUNG
 • DIMENSIONES SIN PANEL

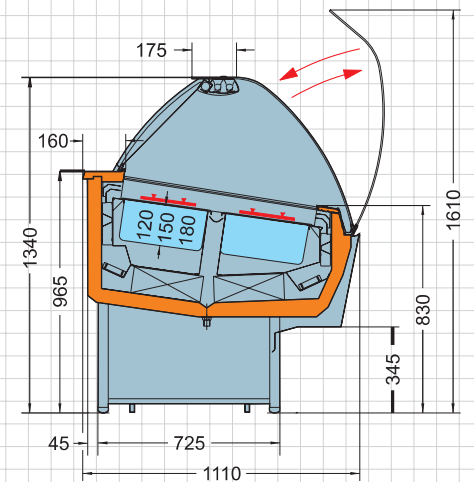
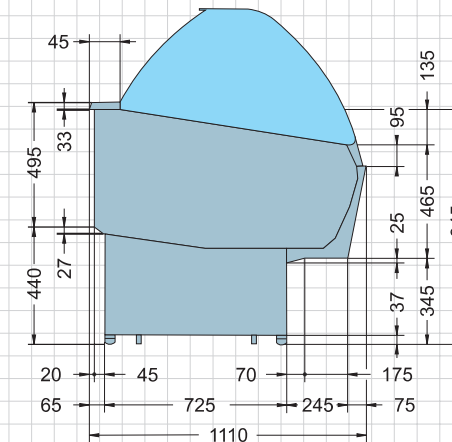
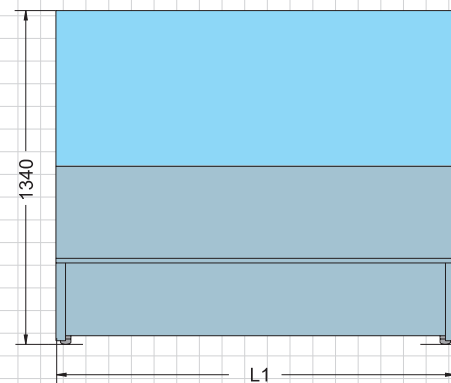

- EVOLUTION 12 L1 = mm 1100
- EVOLUTION 18 L1 = mm 1600
- EVOLUTION 24 L1 = mm 2120
- EVOLUTION 12+12 L1 = mm 2120

GRAN GALÀ 12 / 16 / 18 / 20 / 24 / 12+12

COD. 38 / 37 / 35 / 36 / 40 • DIMENSIONI CON PANNELLI • DIMENSIONS WITH PANELS
 • DIMENSIONS AVEC PANNEAUX • ABMESSUNGEN MIT VERKLEIDUNG • DIMENSIONES CON PANEL

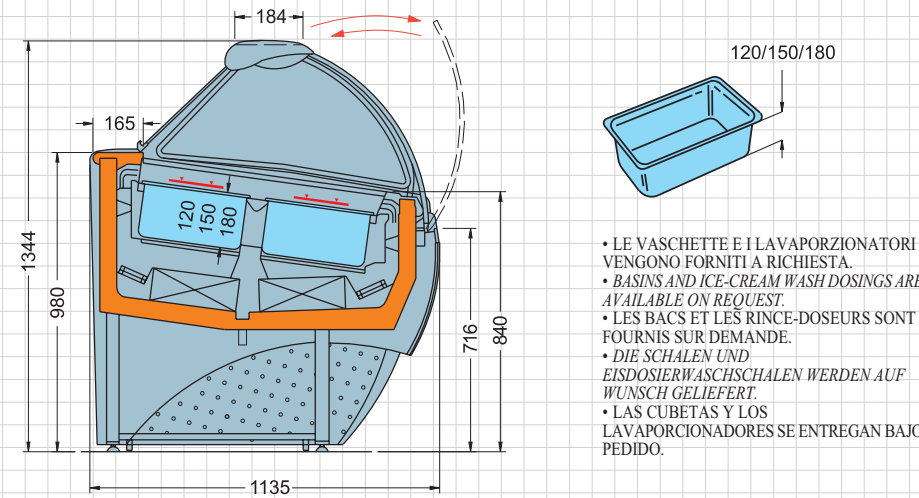
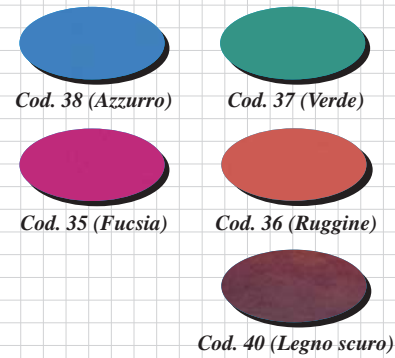
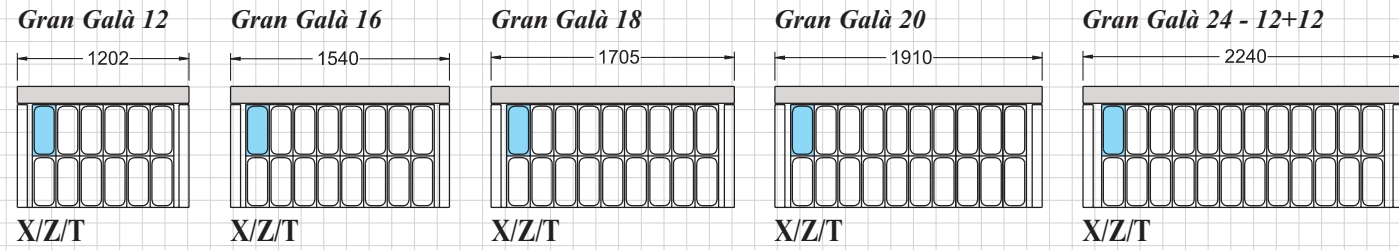

• LE VASCHE E I LAVAPORZIONATORI VENGONO FORNITI A RICHIESTA.
 • BASINS AND ICE-CREAM WASH DOSINGS ARE AVAILABLE ON REQUEST.
 • LES BACS ET LES RINCE-DOSEURS SONT FOURNIS SUR DEMANDE.
 • DIE SCHALEN UND EISDOSIERWASCHSCHALEN WERDEN AUF WUNSCH GELIEFERT.
 • LAS CUBETAS Y LOS LAVAPORCIONADORES SE ENTREGAN BAJO PEDIDO.

GRAN GALÀ 12 / 16 / 18 / 20 / 24 / 12+12

COD. 10 • DIMENSIONI SENZA PANNELLI • DIMENSIONS WITHOUT PANELS
 • DIMENSIONS SANS PANNEAUX • ABMESSUNGEN OHNE VERKLEIDUNG • DIMENSIONES SIN PANEL

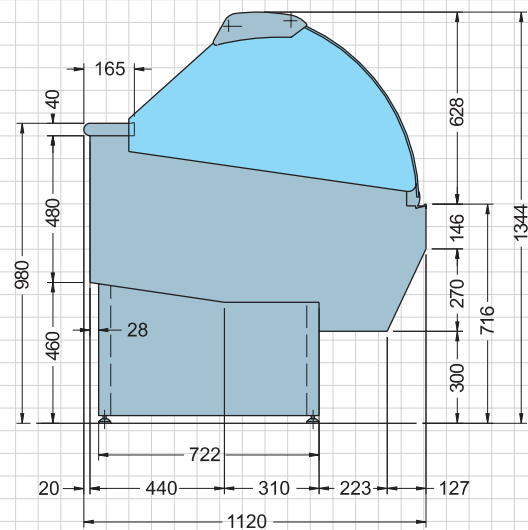
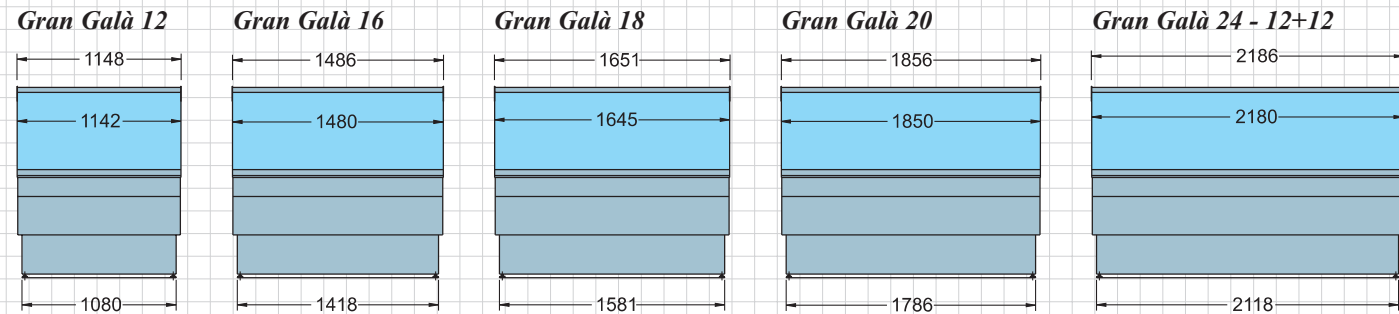

AMBASSADOR 12 / 18 / 24 / 12+12

COD. 46 / 47 / 51 • DIMENSIONI CON PANNELLI • DIMENSIONS WITH PANELS
 • DIMENSIONS AVEC PANNEAUX • ABMESSUNGEN MIT VERKLEIDUNG • DIMENSIONES CON PANEL

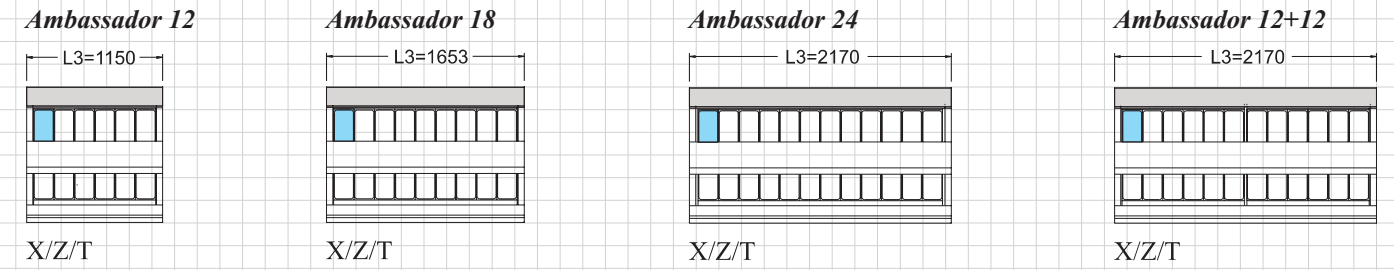

AMBASSADOR 12 L2 = mm 1100 L3 = mm 1150
 AMBASSADOR 18 L2 = mm 1603 L3 = mm 1653
 AMBASSADOR 24 L2 = mm 2120 L3 = mm 2170
 AMBASSADOR 12+12 L2 = mm 2120 L3 = mm 2170

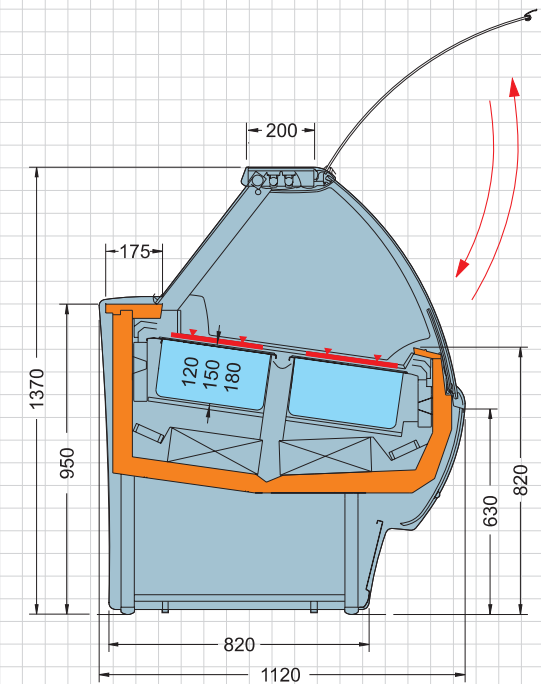
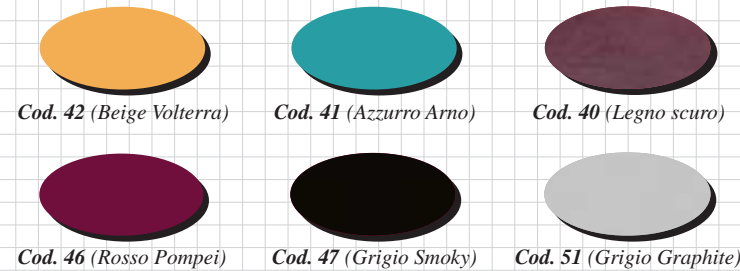
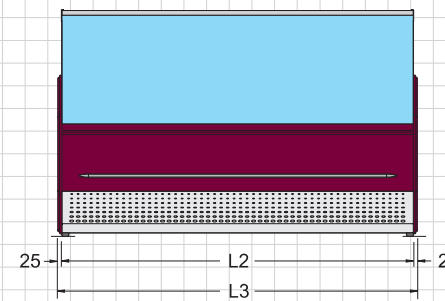

• LE VASCHE E I LAVAPORZIONATORI VENGONO FORNITI A RICHIESTA.
 • BASINS AND ICE-CREAM WASH DOSINGS ARE AVAILABLE ON REQUEST.
 • LES BACS ET LES RINCE-DOSEURS SONT FOURNIS SUR DEMANDE.
 • DIE SCHALEN UND EISDOSIERWASCHSCHALEN WERDEN AUF WUNSCH GELIEFERT.
 • LAS CUBETAS Y LOS LAVAPORCIONADORES SE ENTREGAN BAJO PEDIDO.

AMBASSADOR 12 / 18 / 24 / 12+12

COD. 10 • DIMENSIONI SENZA PANNELLI • DIMENSIONS WITHOUT PANELS
 • DIMENSIONS SANS PANNEAUX • ABMESSUNGEN OHNE VERKLEIDUNG • DIMENSIONES SIN PANEL

AMBASSADOR 12 L2 = mm 1100
 AMBASSADOR 18 L2 = mm 1603
 AMBASSADOR 24 L2 = mm 2120
 AMBASSADOR 12+12 L2 = mm 2120

